

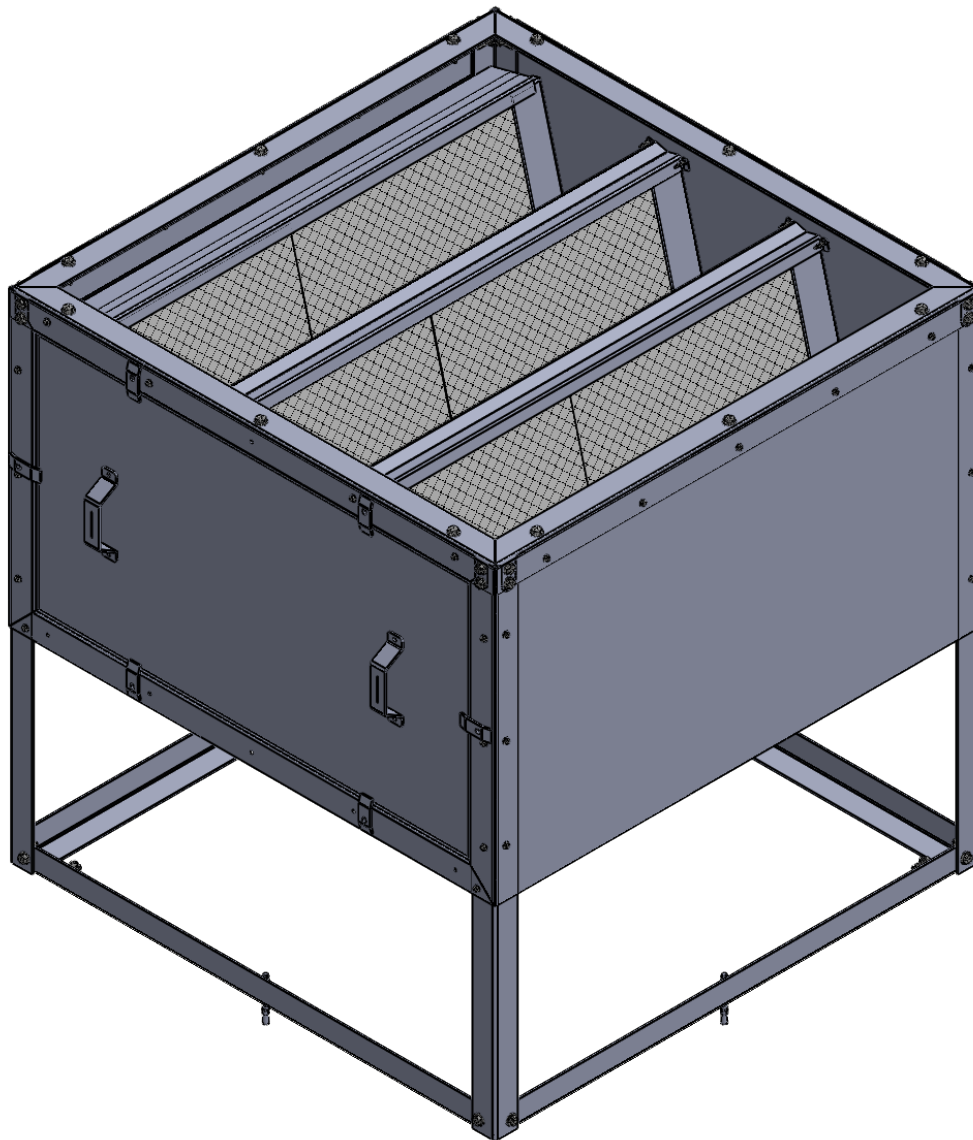

# R1 V STAND

## ASSEMBLY INSTRUCTIONS

12-26-2017



---

13845 PIONEER ROAD, UNIT 7  
APPLE VALLEY, CA 92307  
909-331-5593



## PARTS LIST

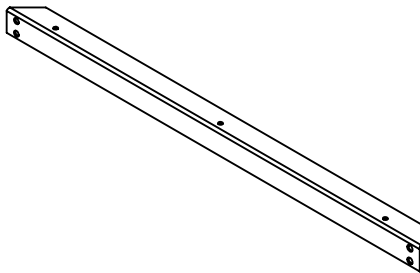

**A**

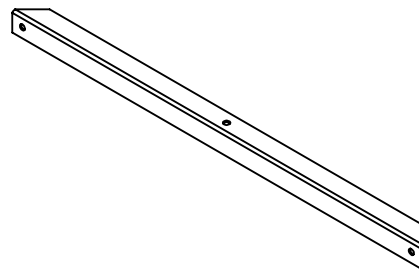

**B**

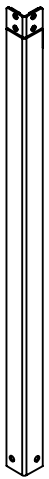

**C**

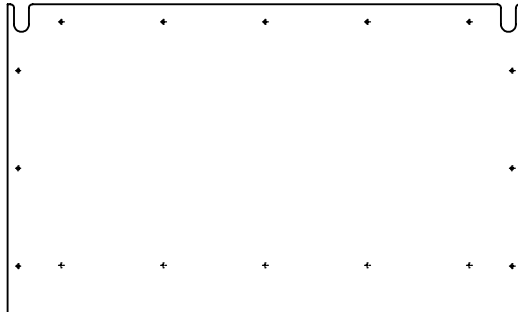

**D**

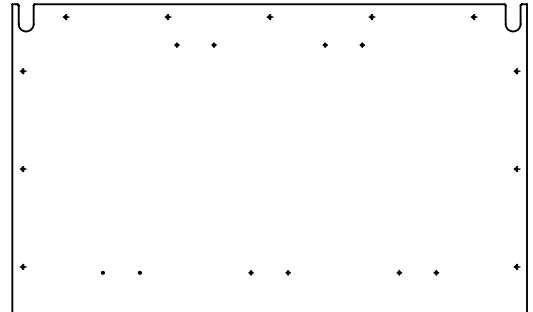

**E**



**H**

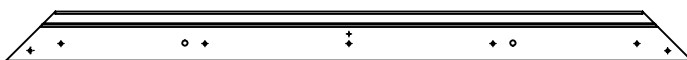

**I**

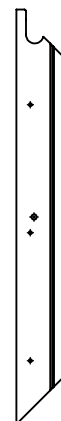

**F**

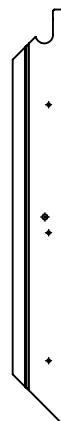

**G**



## PARTS LIST

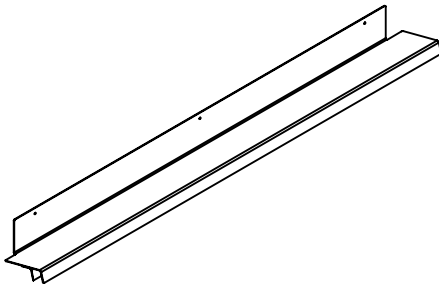

**J**

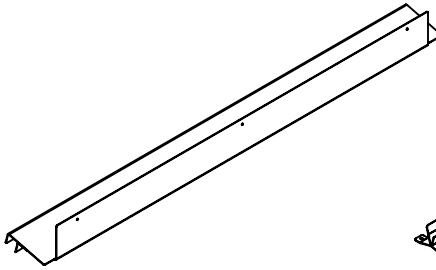

**K**

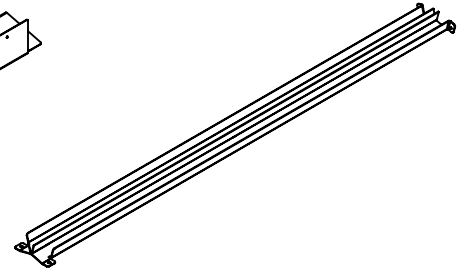

**L**

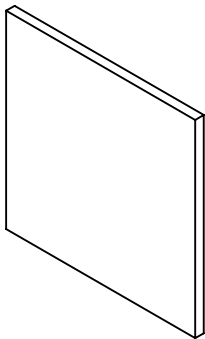

**M**

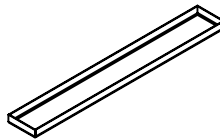

**N**

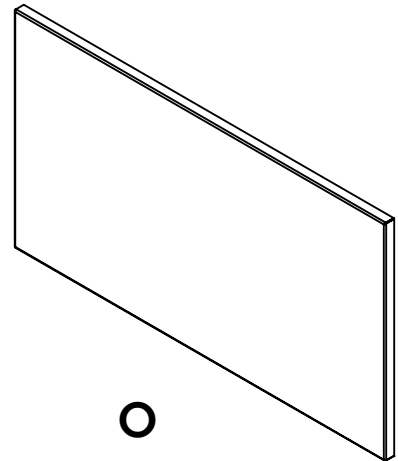

**O**

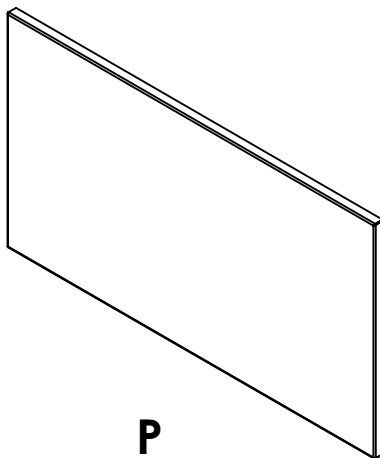

**P**

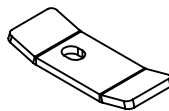

**Q**

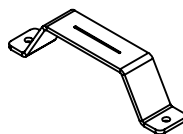

**R**

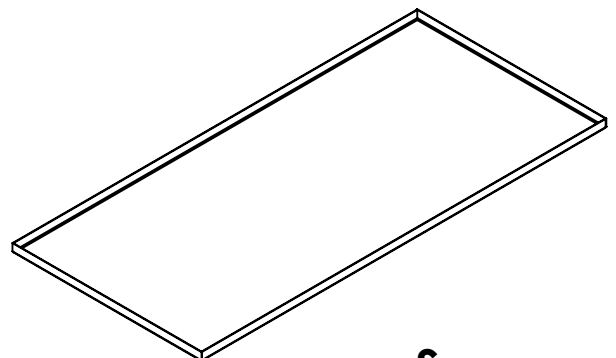

**S**



## PARTS LIST

ITEMS	DESCRIPTION	QUANTITY
A	TOP FRAME SEGMENT	4
B	BOTTOM FRAME SEGMENT	4
C	LEG FRAME	4
D	SIDE PANEL	2
E	BACK PANEL	1
F	LEFT DOOR FRAME	1
G	RIGHT DOOR FRAME	1
H	TOP DOOR FRAME	1
I	BOTTOM DOOR FRAME	1
J	SIDE LEFT-HAND RAIL	1
K	SIDE RIGHT_HAND RAIL	1
L	FILTER RAIL	5
M	FILTER	12
N	FILTER SPACER	6
O	FILTER DOOR	1
P	FILTER DOOR COVER	1
Q	DOOR CLIPS	6
R	DOOR HANDLE	2
S	BLOCK-OFF PLATES	3



## HARDWARE

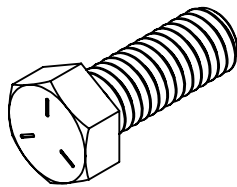

**B1**

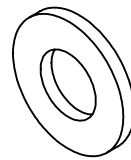

**W1**

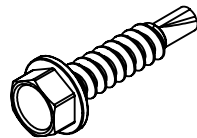

**T1**

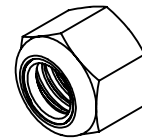

**N1**

ITEM	PART NUMBER	DESCRIPTIONS	QUANTITY
B1	92865A624	3/8"-16 X 1" Bolts	36
W1	90126A031	3/8" SAE Flat Washers	56
N1	97135A230	3/8"-16 Nylon LockNuts	20
T1	90064A581	#12 X 1 " TEK Screws	69
		Door Seal	

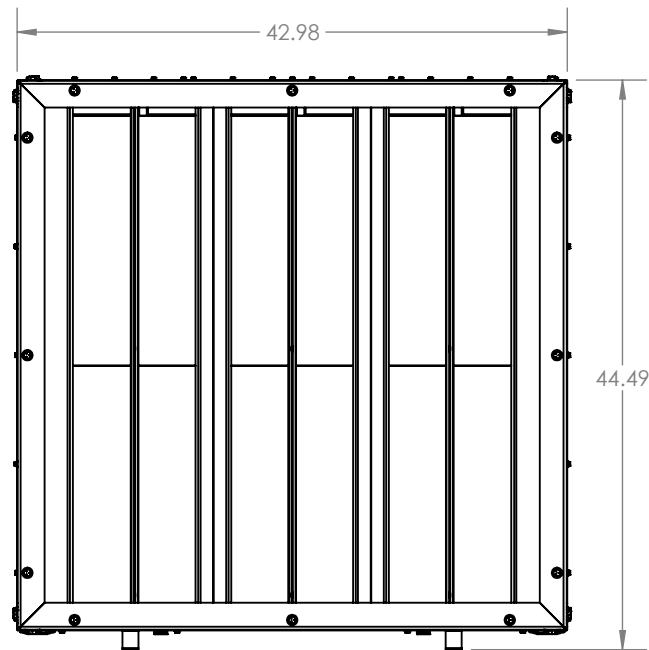

**TOP VIEW**

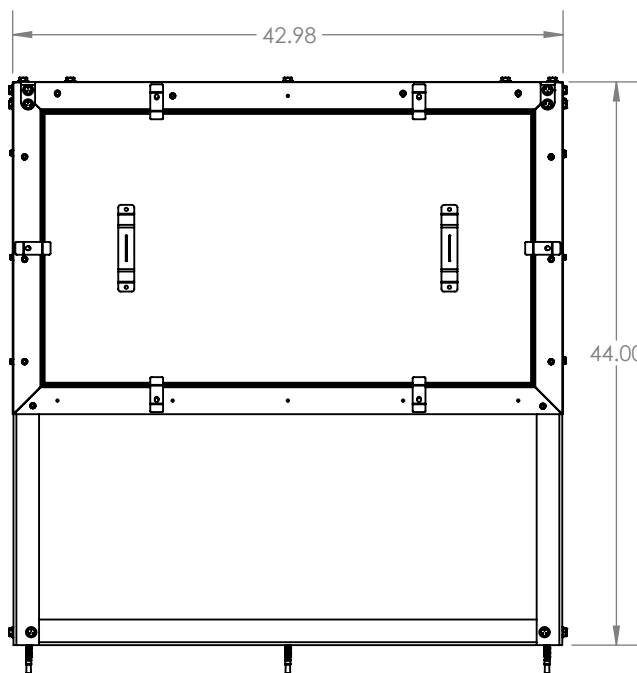

**FRONT VIEW**

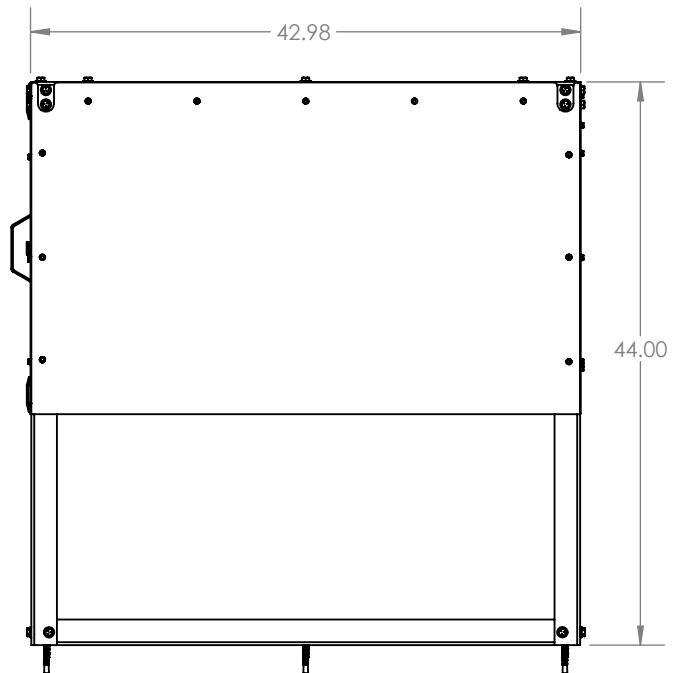

**SIDE VIEW**



## STEP 1

- Assemble the top frame (A).
- Bolt legs (C) to top frame (A) with 3/8"-16 x 1" bolts (B1) and 3/8" SAE washers (W1).

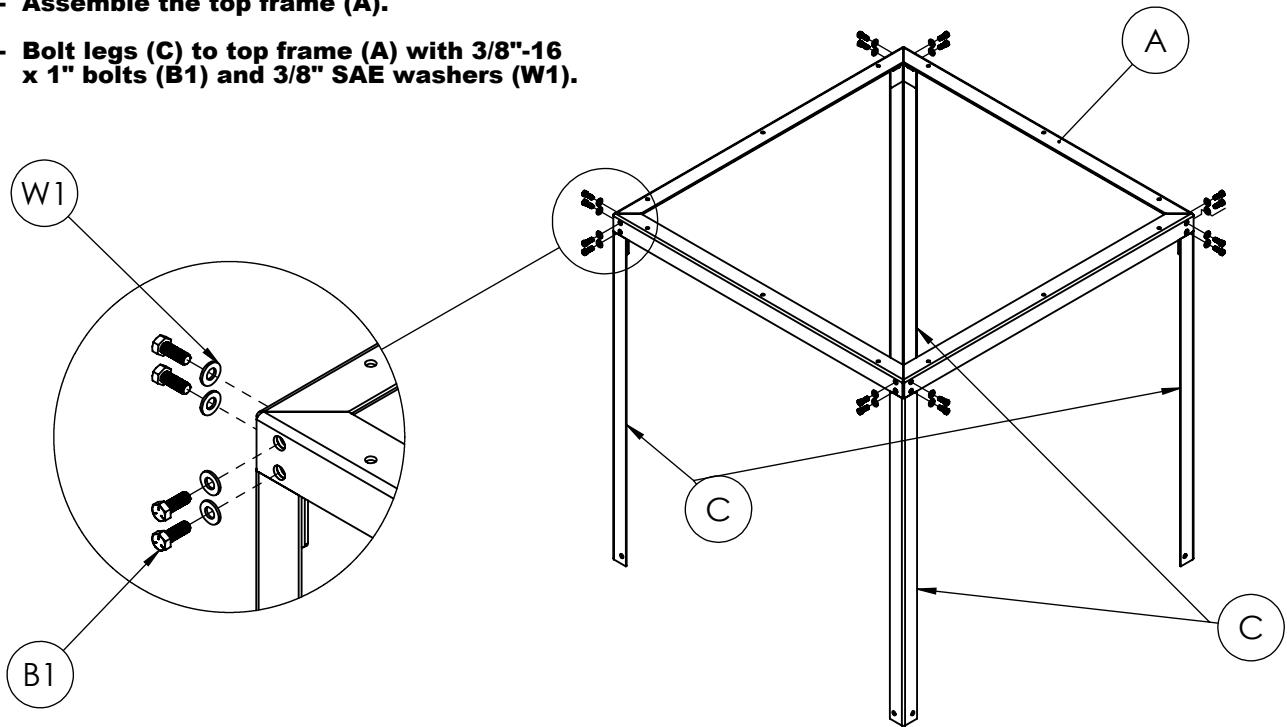

## STEP 2

- Bolt bottom frame (B) to legs (C) with 3/8"-16 x 1" (B1), 3/8" washers (W1), and 3/8"-16 nylock nuts (N1).

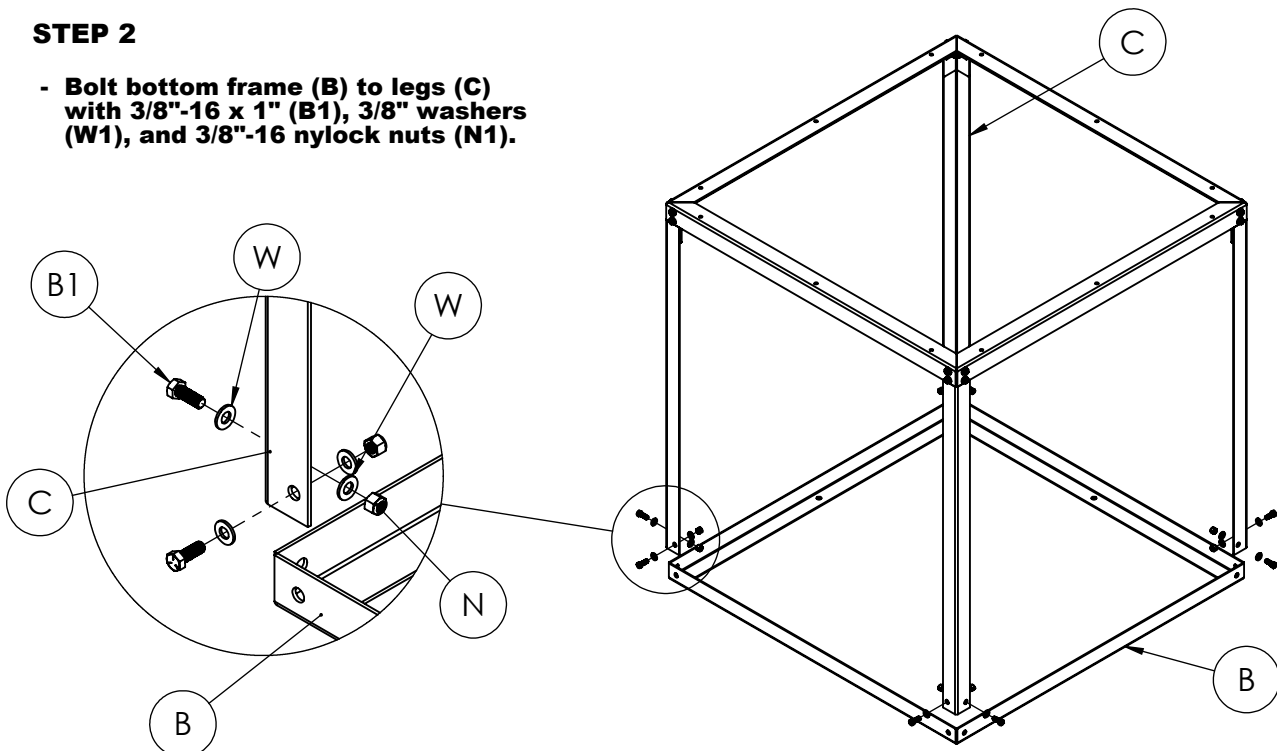



### STEP 3

- Verify that frame is square.
- Screw the 2 side panels (D) in place with #12 x 1" tek screws (T1).
- Screw the back panel (E) in place with #12 x 1" tek screws (T1).
- Verify the orientation of back panel is correct.

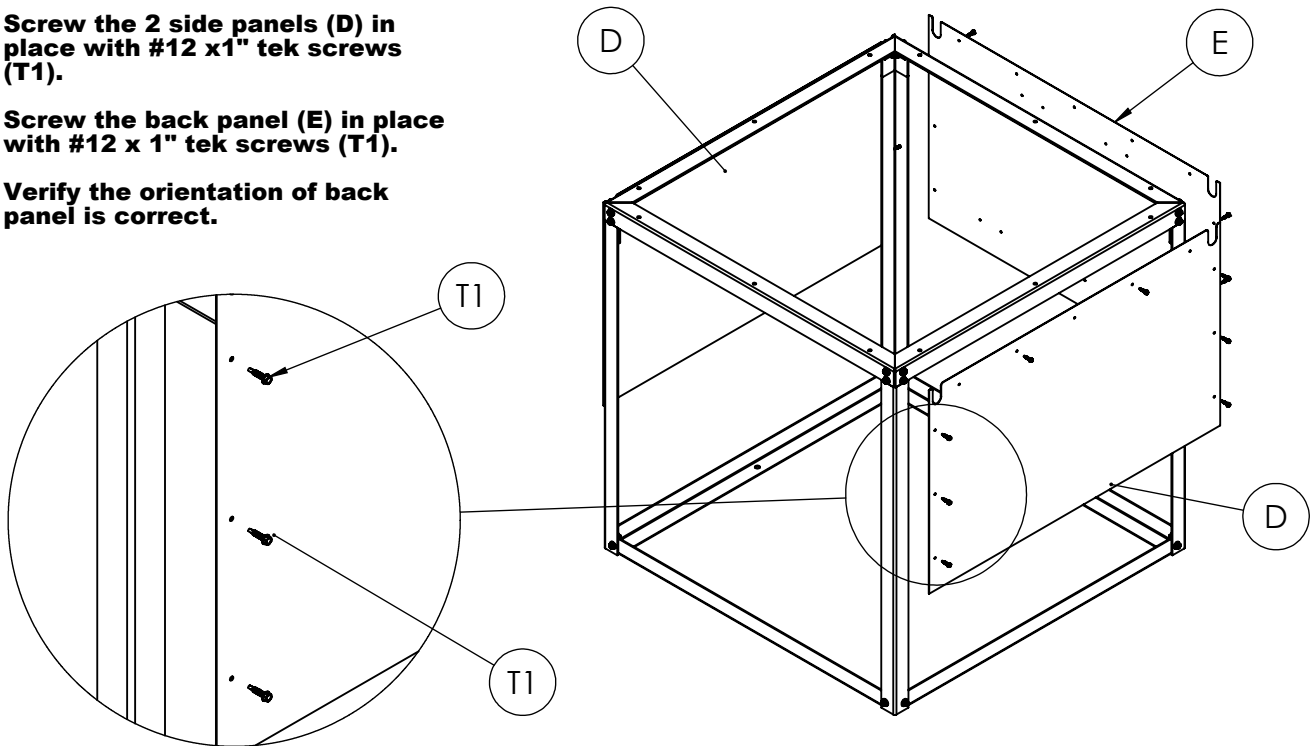

### STEP 4

- Install top (H), bottom (I), left (F), right (G) door frames with #12 x 1" tek screws (T1).
- Verify that their orientation is correct.

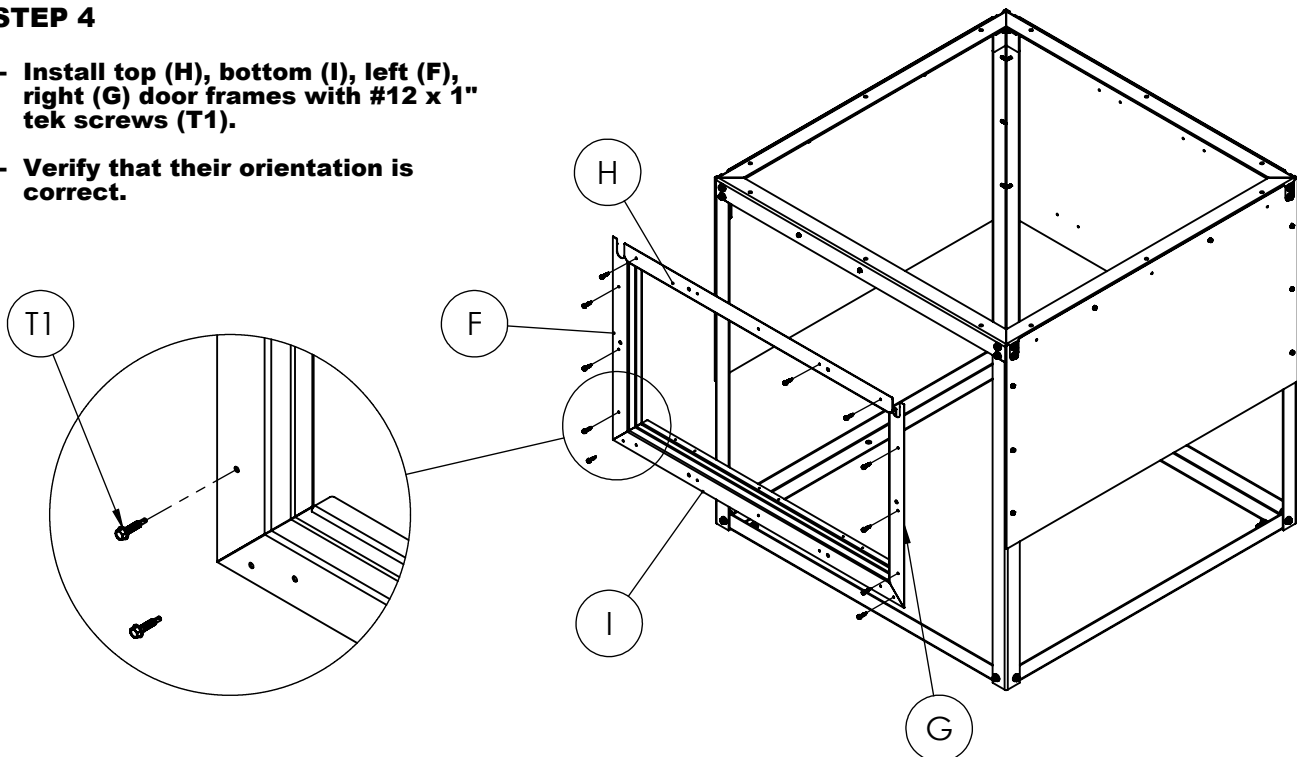





## STEP 5

- Screw L hand side rail (J) in place with #12 x 1" tek screws (T1).
- Caulk ends of rails.

Facing at the left side

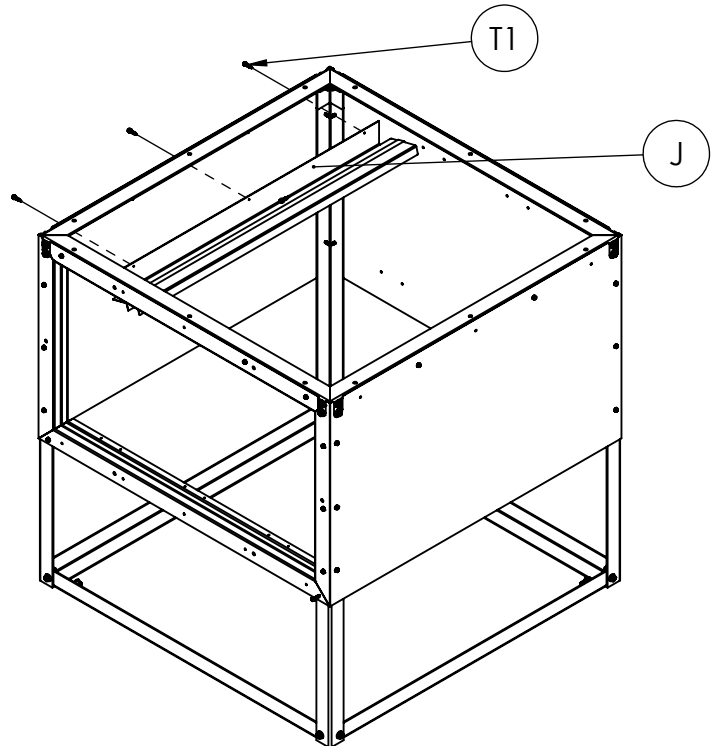
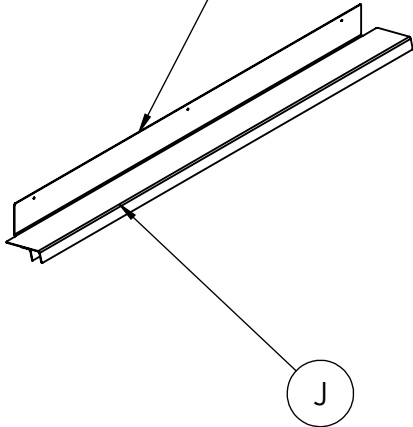

## STEP 6

- Screw R hand side rail (K) in place with #12 x 1" tek screws (T1).
- Caulk ends of rails.

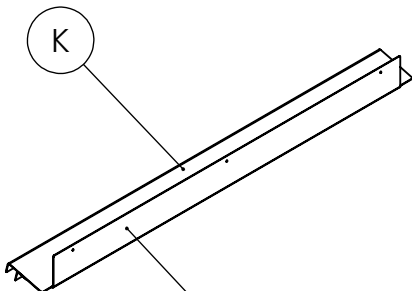

Facing at the right side

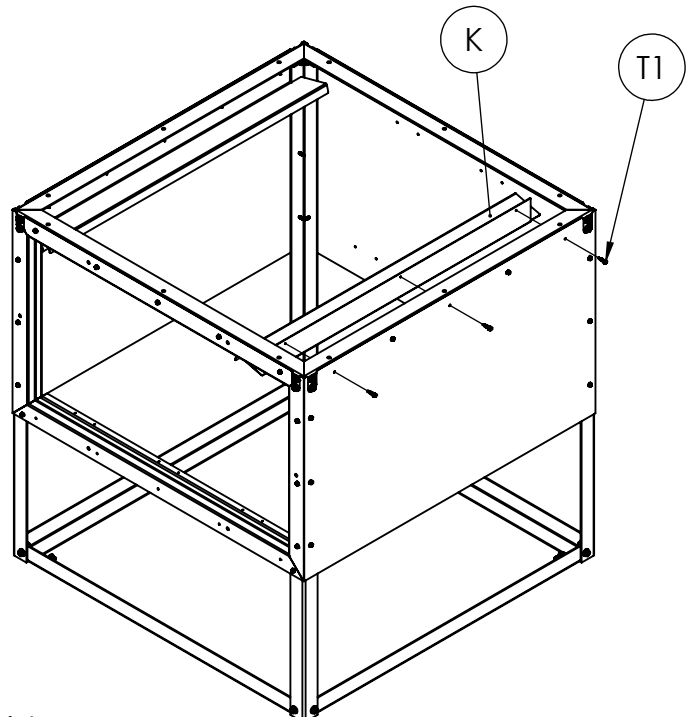



## STEP 7

- Secure the 5 filter rails (L) to the back panel (E) with #12 x 1" tek screws (T1).

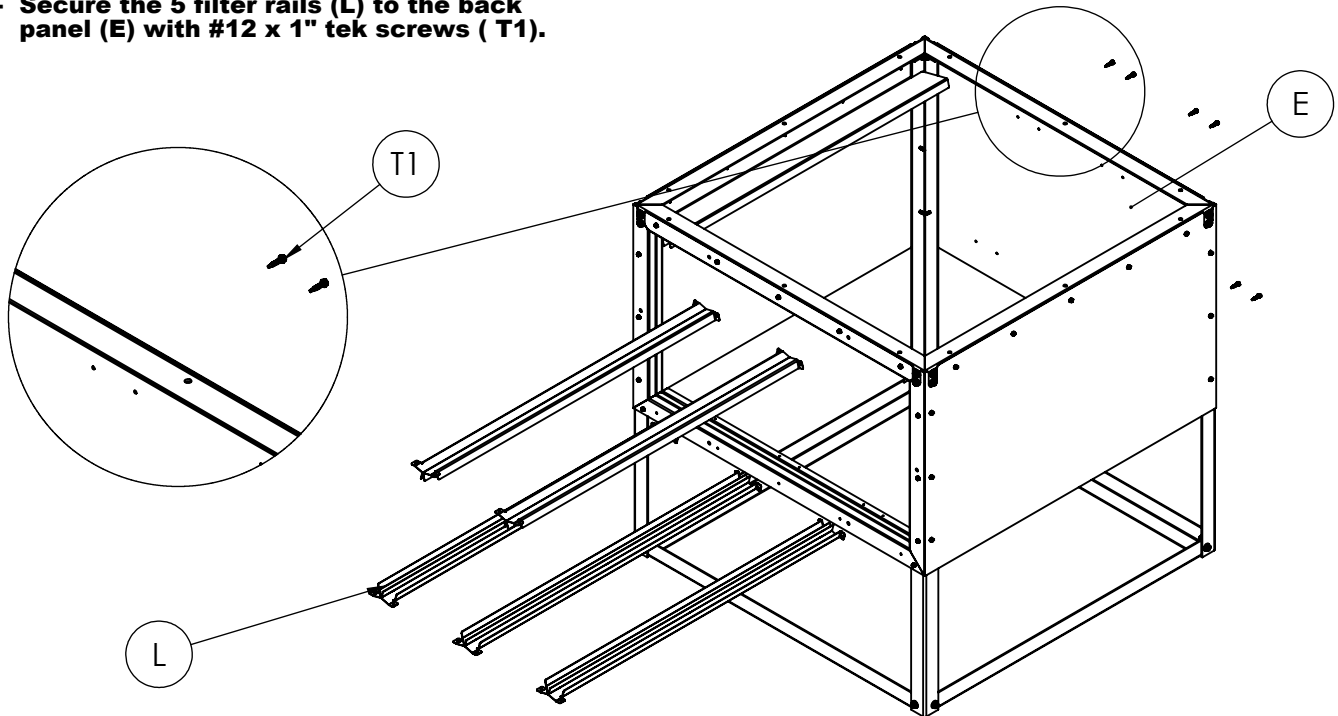

## STEP 8

- Secure the filter rails (L) to the top (H) and bottom (I) door frames with #12 x 1" tek screws (T1).

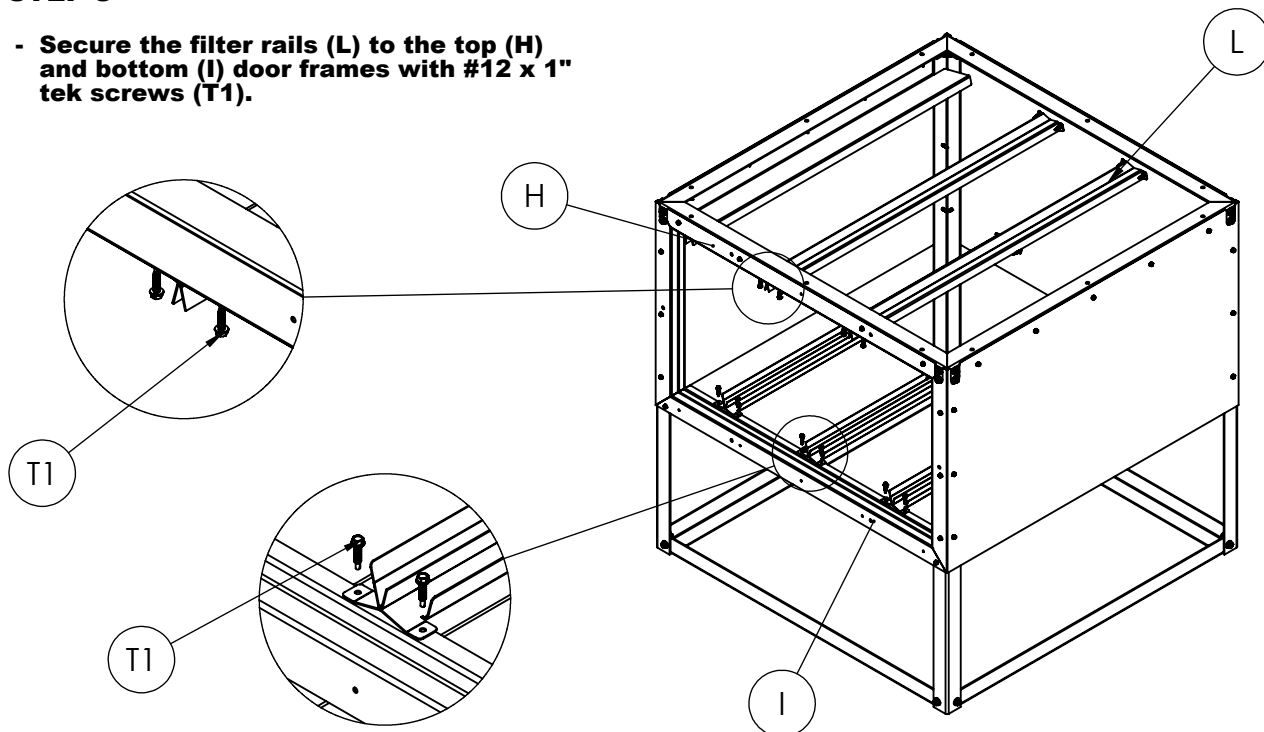



## STEP 9

- Install 6 pcs door clip (Q) on the frame with 5/16" screws.

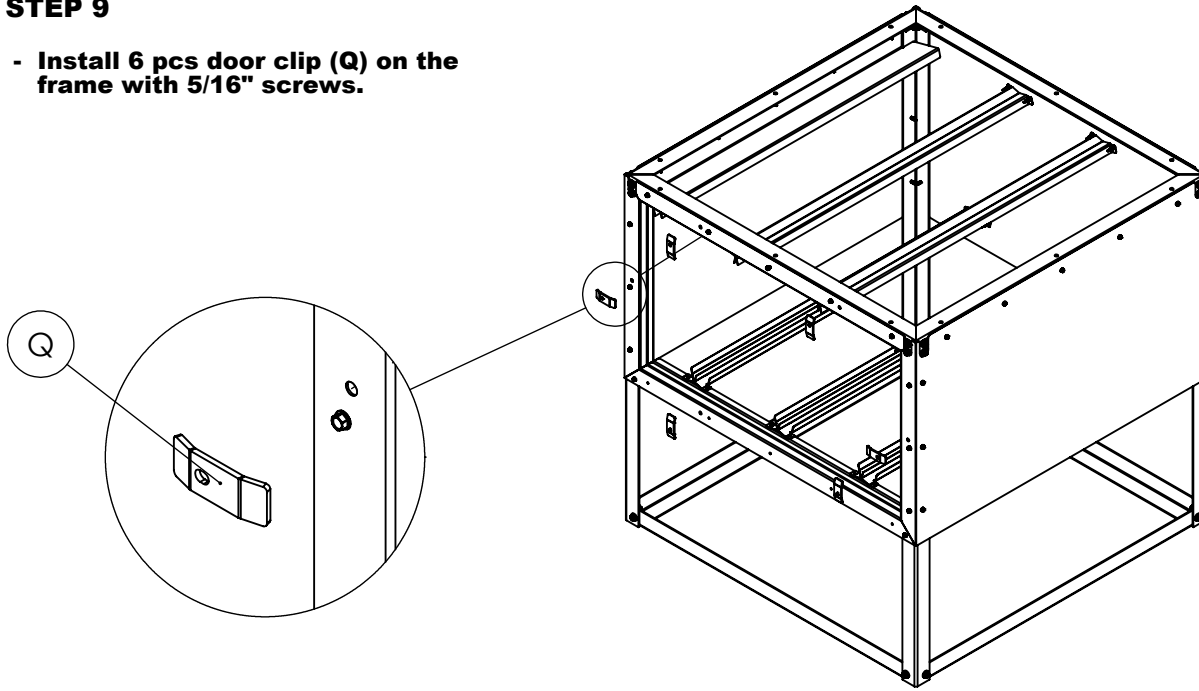

## STEP 10

- Bolt stand to concrete slab using at least 4 pcs of 3/8" x 4" wedge anchor bolts ( not supplied ).

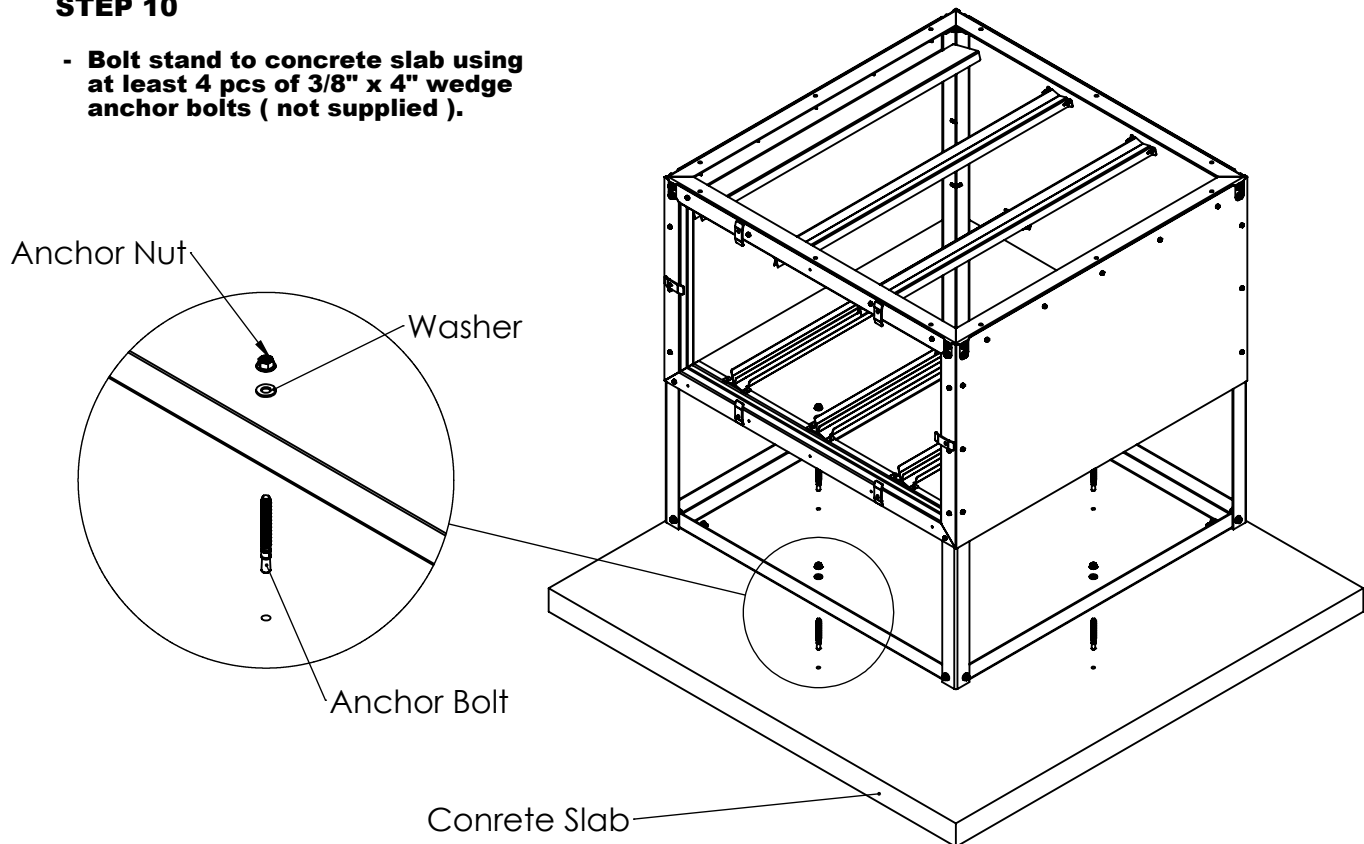



## STEP 11

- Set heater onto stand.
- Support heater until it is bolted to stand.
- Bolt heater to stand with 3/8"-16 x 1" bolts (B1), 3/8" SAE washers (W1), and 3/8"-16 nyloc nuts (N1).

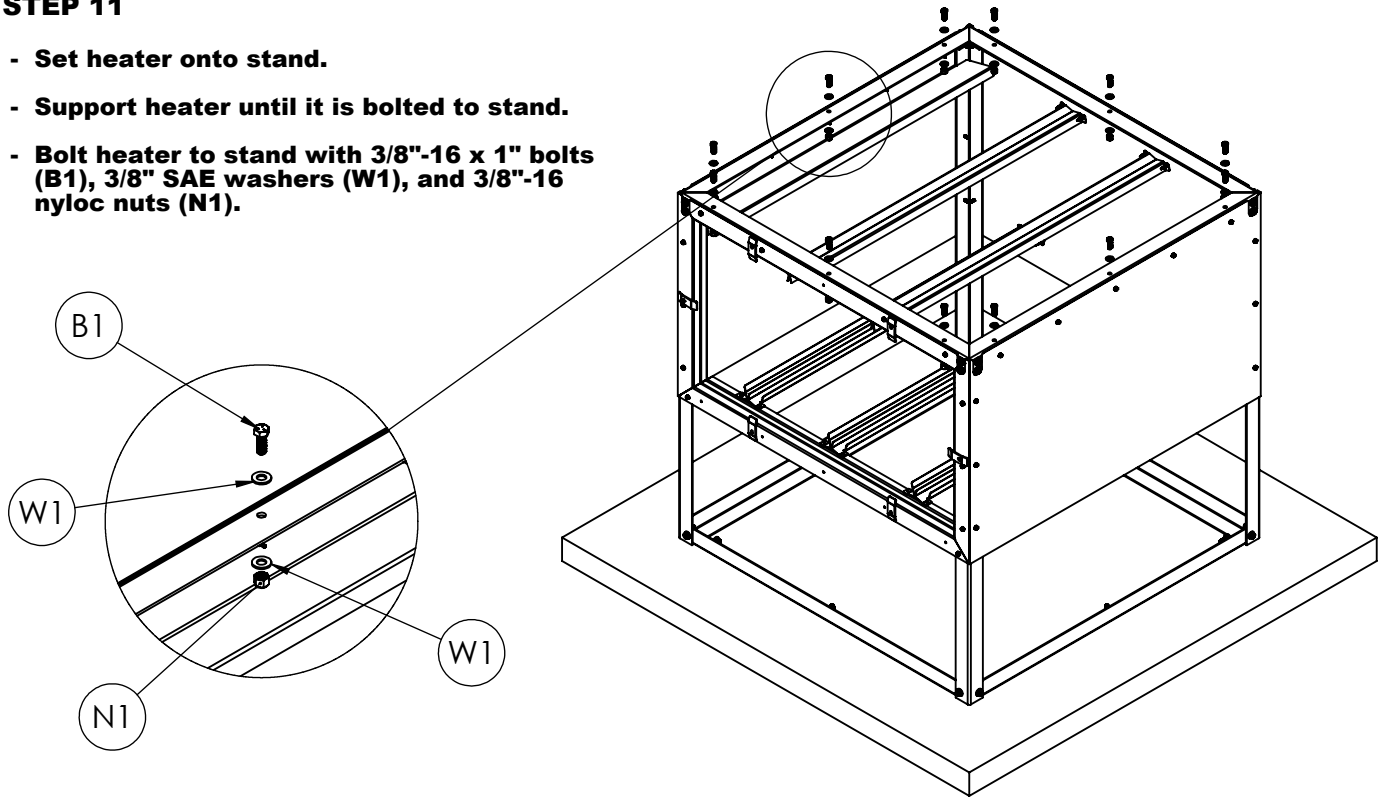

## STEP 12.A

### Option 1 (Default Filter)

- Install spacers (N) into filter rails (L).
- Install filters (M) into filter rails (L).

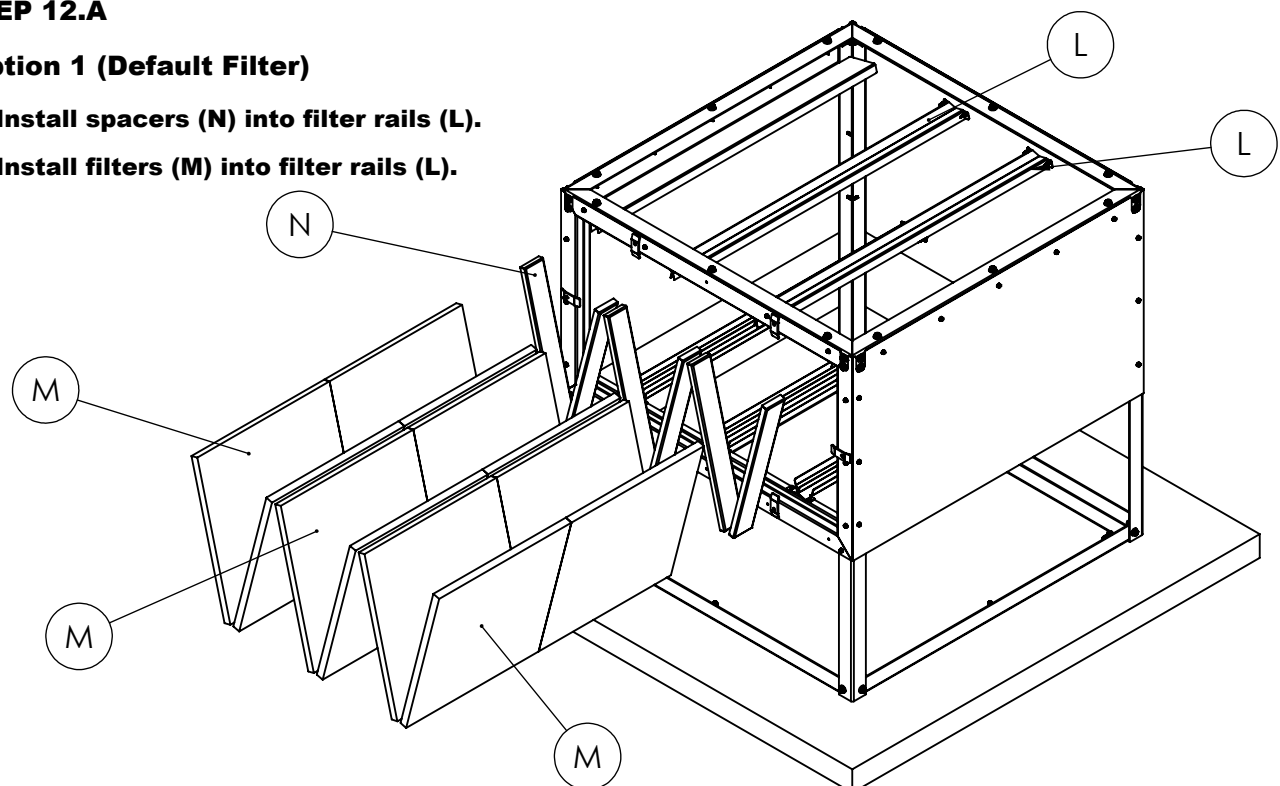



## STEP 12.B

### Option 2 (Aluminum Filter)

- Install 3 pcs spacers (N) into filter rails (L).
- Install 6 pcs filters (M) into filter rails (L).
- Install 3 pcs block-off plates (S).

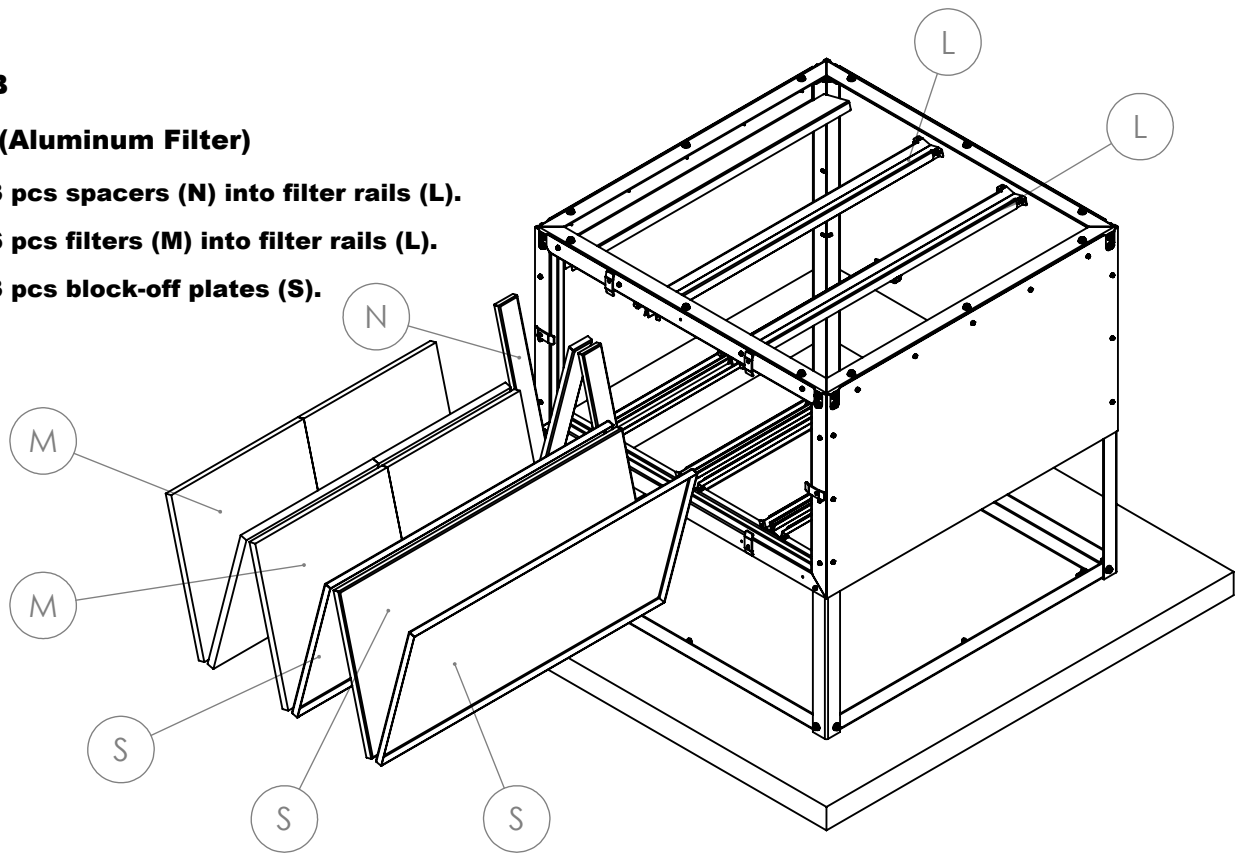

## STEP 13

- Assemble door with parts filter door (O), filter door cover (P) and door handle (R).
- Install foam door seal.
- Install filter door (O).

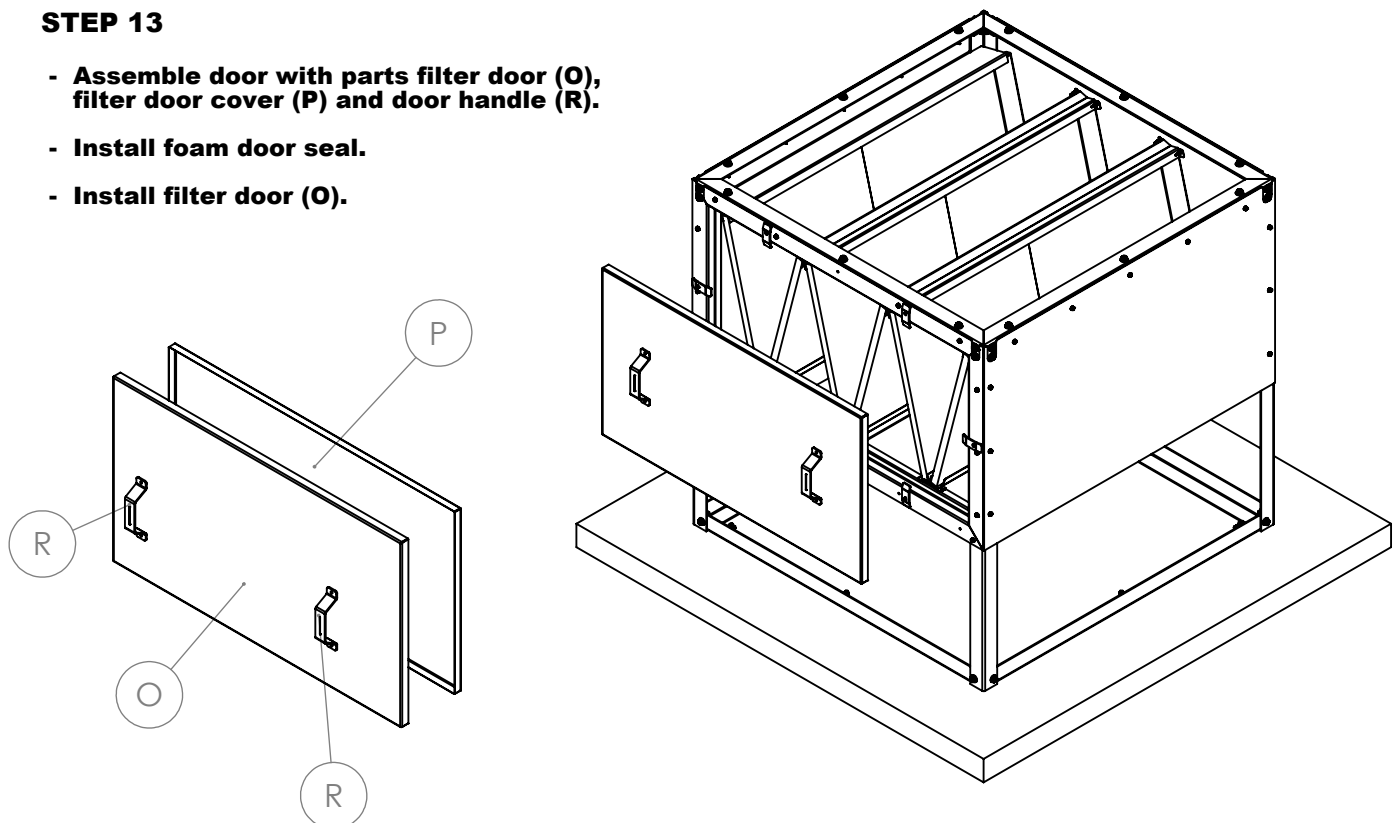



**CONGRATULATIONS !!!!**

**You have finished your R1 Stand assembly.**

